

Аварийный выпускной комплект F-Kit

Технические характеристики

По вопросам продаж и поддержки обращайтесь:

Алматы (727)345-47-04
Ангарск (3955)60-70-56
Архангельск (8182)63-90-72
Астрахань (8512)99-46-04
Барнаул (3852)73-04-60
Белгород (4722)40-23-64
Благовещенск (4162)22-76-07
Брянск (4832)59-03-52
Владивосток (423)249-28-31
Владикавказ (8672)28-90-48
Владимир (4922)49-43-18
Волгоград (844)278-03-48
Вологда (8172)26-41-59
Воронеж (473)204-51-73
Екатеринбург (343)384-55-89

Иваново (4932)77-34-06
Ижевск (3412)26-03-58
Иркутск (395)279-98-46
Казань (843)206-01-48
Калининград (4012)72-03-81
Калуга (4842)92-23-67
Кемерово (3842)65-04-62
Киров (8332)68-02-04
Коломна (4966)23-41-49
Кострома (4942)77-07-48
Краснодар (861)203-40-90
Красноярск (391)204-63-61
Курск (4712)77-13-04
Курган (3522)50-90-47
Липецк (4742)52-20-81

Магнитогорск (3519)55-03-13
Москва (495)268-04-70
Мурманск (8152)59-64-93
Набережные Челны (8552)20-53-41
Нижний Новгород (831)429-08-12
Новокузнецк (3843)20-46-81
Ноябрьск (3496)41-32-12
Новосибирск (383)227-86-73
Омск (3812)21-46-40
Орел (4862)44-53-42
Оренбург (3532)37-68-04
Пенза (8412)22-31-16
Петрозаводск (8142)55-98-37
Псков (8112)59-10-37
Пермь (342)205-81-47

Ростов-на-Дону (863)308-18-15
Рязань (4912)46-61-64
Самара (846)206-03-16
Санкт-Петербург (812)309-46-40
Саратов (845)249-38-78
Севастополь (8692)22-31-93
Саранск (8342)22-96-24
Симферополь (3652)67-13-56
Смоленск (4812)29-41-54
Сочи (862)225-72-31
Ставрополь (8652)20-65-13
Сургут (3462)77-98-35
Сыктывкар (8212)25-95-17
Тамбов (4752)50-40-97
Тверь (4822)63-31-35

Тольятти (8482)63-91-07
Томск (3822)98-41-53
Тула (4872)33-79-87
Тюмень (3452)66-21-18
Ульяновск (8422)24-23-59
Улан-Удэ (3012)59-97-51
Уфа (347)229-48-12
Хабаровск (4212)92-98-04
Чебоксары (8352)28-53-07
Челябинск (351)202-03-61
Череповец (8202)49-02-64
Чита (3022)38-34-83
Якутск (4112)23-90-97
Ярославль (4852)69-52-93

Россия +7(495)268-04-70

Казахстан +(727)345-47-04

Беларусь +(375)257-127-884

Узбекистан +998(71)205-18-59

Киргизия +996(312)96-26-47

эл.почта: ddo@nt-rt.ru || сайт: <https://dold.nt-rt.ru/>

Content

Symbol and Notes Statement.....	8
General Notes	8
Notes	8
Product Description	9
System Components of the F-Kit.....	9
Approvals and Markings	9
Applications	9
Design and Function.....	10
Emergency-Stop Function	10
Activation of the Mechanical Escape Release.....	10
Reset Function	10
Notes	11
Function.....	11
Technical Data	11
Variants and Combination Options	11
Ordering Designation.....	11
Dimensional Drawings [mm]	12
Notice	19

Symbol and Notes Statement



DANGER:
Indicates that death or severe personal injury will result if proper precautions are not taken.



WARNING:
Indicates that death or severe personal injury can result if proper precautions are not taken.



CAUTION:
Indicates that a minor personal injury can result if proper precautions are not taken.



INFO:
Referred information to help you make best use of the product.



ATTENTION:
Warns against actions that can cause damage or malfunction of the device, the device environment or the hardware / software result.

General Notes

The product hereby described was developed to perform safety functions as a part of a whole installation or machine. A complete safety system normally includes sensors (SAFEMASTER STS System), evaluation units, signals and logical modules for safe disconnections. The manufacturer of the installation or machine is responsible for ensuring proper functioning of the whole system. DOLD cannot guarantee all the specifications of an installation or machine that was not designed by DOLD. The total concept of the control system into which the device is integrated must be validated by the user. DOLD also takes over no liability for recommendations which are given or implied in the following description. The following description implies no modification of the general DOLD terms of delivery, warranty or liability claims.

Notes



Risk!
Danger to life or risk of serious injuries.

- Hazards must be ruled out before a key can be entered and the movable part of the guard can then be opened!



INFO

- For information regarding use in the system and validation according to EN ISO 13849-2, see SAFEMASTER STS application guide.
- Take advantage of the advice of the **E. Dold & Söhne GmbH & Co. KG** specialists regarding the choice of units and combination of a system.



ATTENTION !

- To avoid wrong usage (e.g. by overload, mounting position or usage in acid, alkaline or other hostile ambient conditions) the limitations of the product have to be observed. Please check in advance if your application requires the usage of the more robust stainless steel model of SAFEMASTER STS. The requirements of the mounting and operating instruction must be fulfilled.



Before installing, operating or maintaining this device, these instructions must be carefully read and understood.



The installation must only be done by a qualified electrician!



The installation must only be done by a qualified mechanic!



Do not dispose of household garbage!
The device must be disposed of in compliance with nationally applicable rules and requirements.



Storage for future reference.

To help you understand and find specific text passages and notes in the operating instructions, we have important information and information marked with symbols.

SAFEMASTER STS Safety Switch- and Key Interlock System Escape Release F-Kit

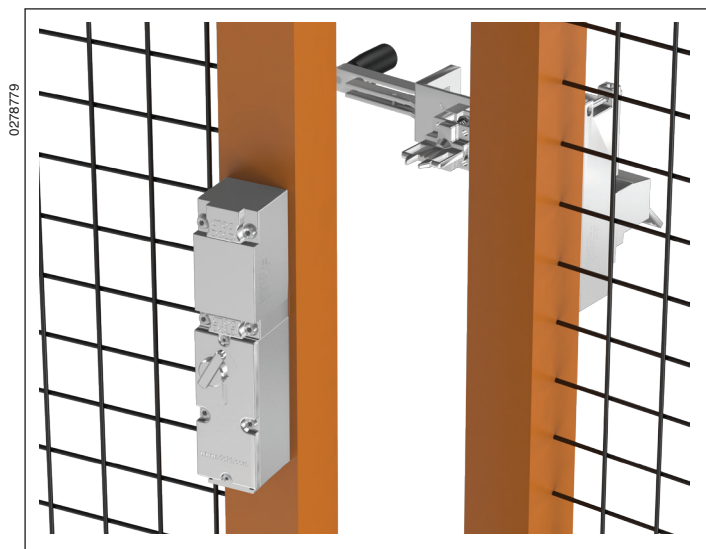

STS-System Benefits

- For safety applications up to PLe/Category 4 according to DIN EN/ISO 13849-1
- Modular and expandable system
- Rugged stainless steel design
- Wireless mechanical safeguarding
- Combines the benefits of safety switch, locking module and key transfer in a single system
- Easy installation through comprehensive accessories
- Protection against lock-in
- Coding level low, medium, high according to DIN EN ISO 14119:2014-03

Features

- Kit for retrofitting additional escape functions for existing locking units
- Modular expansion possible
- Little wiring work
- For rugged environments

Product Description

Additional function by combining three subsystems of modules of the SAFEMASTER STS System, which in its described arrangement allows a locked-in person to escape.

Approvals and Markings



System Components of the F-Kit

Actuator F-Kit

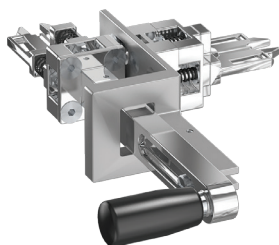

Monitoring unit SVBM (right)
inside the hazard area

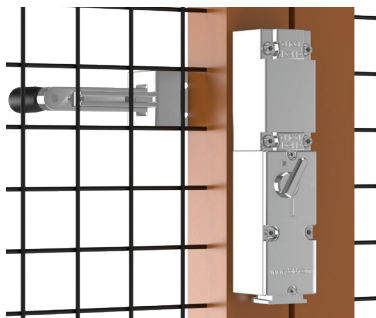

Applications

Application with additional retrofitted escape release for secured and separating guards using STS locking module units. Especially for plants with high risk of lock-in and injuries.

SAFEMASTER STS-F-Kit is a combination of 2 units acting jointly via one actuator. Access via a STS locking unit available at the customer (see example M10A). The monitoring unit SVBM, ensures possible escape from the inside of a plant. The guard can be opened and an emergency-stop is triggered via a lever on this monitoring unit. The readiness for operation the F-Kit can only be made operational again via a proper reset (see section on Reset Function). In addition, the application must be connected to a control unit in a manner that allows the hazardous machine to start only when the guard is locked and closed.

Locking unit M10A (left) and
Actuator F-Kit (right)
outside the hazard area

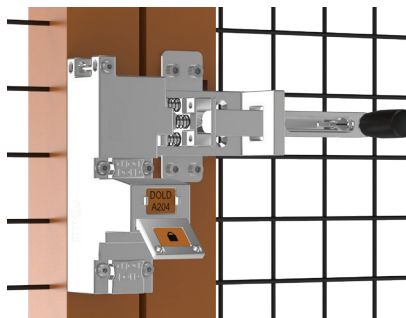

Design and Function

Locking unit

Contrary to normal STS key transfer systems, the first locking unit is not installed on the stationary but directly on the movable part of a separating guard (see e. g. M10A at the lower left of the figure). The customer can combine the locking unit as desired and adapt it to his preferences.

Monitoring unit

The monitoring unit is defined for one SVBM unit and contains the actual escape release and its monitoring. It is mounted to the inside of the stationary part of the separating guard. The switching module SV is thereby directed toward the inside of the plant, the actuator module B toward the outside through the post.

Actuator F-Kit

It consists of two actuators connected via a spacer and allowing the combined action of locking and monitoring unit through a cut-out in the guard. A profile insert is installed in the cut-out.

Emergency-Stop Function

An emergency-stop must be triggered when activating the escape release. The switching contacts in the switch module SV are switched via the mechanism in the actuator module by removing the actuator. The contacts must therefore belong at least to one emergency-stop circuit. Furthermore, we recommend combining the escape release with acoustic and visual warning signals and a locking feature on the control level.

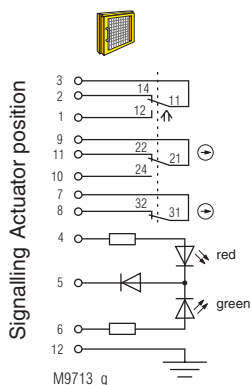

Fig. 1: (Switch module SV)
Escape release in the operating mode: actuator F-Kit plugged, Door closed

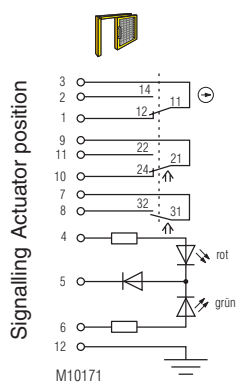

Fig. 2: (Switch module SV)
Escape release activated: Lever pushed up, actuator F-Kit removed, Door open

Switching logic

			Fig. 1	Fig. 2
Door contacts	3	2		
	3	1		
	9	11		
	9	10		
	7	8		

■ closed
□ open

Activation of the Mechanical Escape Release

Starting situation:

The guard is closed.

The guard can be opened (2nd) when the lever of the monitoring unit SVBM unit is pushed up (1st) for escape. The actuator F-Kit then remains in the locking unit mounted on the outside (M10A in this example).

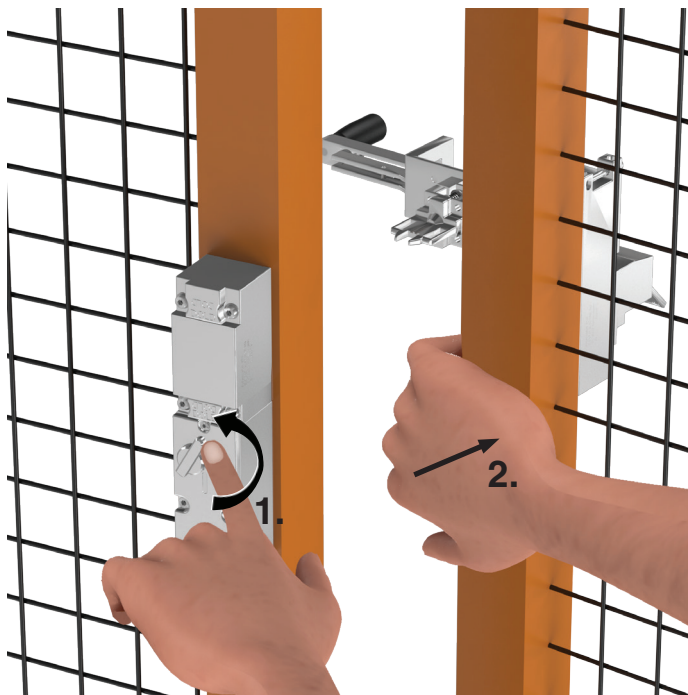

Reset Function

The reset function of the escape release may be performed only when the actuator F-Kit is removed from the locking unit. The locking unit must therefore be properly unlocked via the key transfer sequence provided. Independently from the design of the emergency-stop circuits the unexpected start of the plant during the reset is thus excluded.

When performing the reset, the actuator F-Kit is reset (3rd) with the help of a tool (e.g. screwdriver) through 2 holes in the sliding bolt. The lever of the switch module SV must then jump to the closed position (4th). Removing the actuator must then no longer be possible! Further information see mounting / operating instructions.

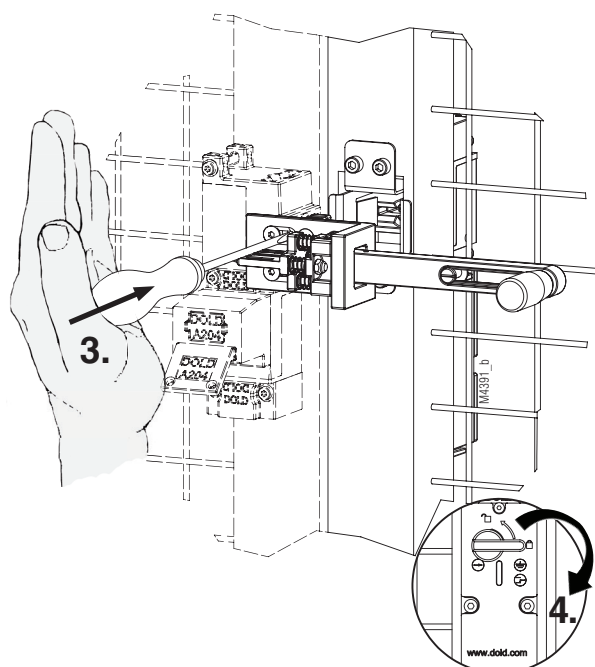

Notes



ATTENTION !

The operator must ensure that the F-Kit actuator freely available after activation of the escape function cannot be used to manipulate other safety devices located on site. (For example, by coding all actuators)

Overload

Overload of the system does not lead to the failure of the safety function. The springs of the actuator reduce the shock stress. If an overload still occurs, the mechanical parts of the module deform in a plastic manner which causes the ejection of the actuator; at least one of the safety circuits opens then. A reset is no longer possible in this case because of the damage and the defective parts must be replaced. Refer to the Overload customer information for additional details.

Loosening the cover of the switch module SV

The mechanical escape release is activated by loosening the cover.

Destroying/loosening the lever of the switch module SV

The escape release is automatically activated when part of the lever of the switch module SV of the escape release is loosened or destroyed.

Function

Attention!



The cut-out and the retainers both for the profile insert and the actuator module of the monitoring unit must be integrated in the guard according to the customer drawing. The escape release and its installation are designed for a guard with frame profile with a diameter area of $A = 50 \text{ mm} \times 50 \text{ mm}$.

Other post dimensions must be queried separately because of special adjustments!

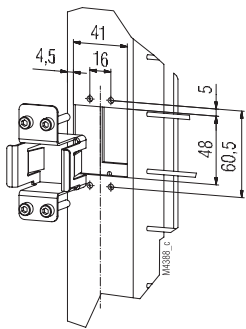

outside the hazard area

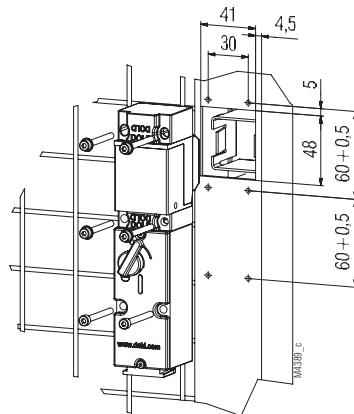

inside the hazard area

Technical Data

For the technical data refer to the data sheets of the individual modules or units.

Individual modules of the system components of the STS-F-Kit:

Switch modules SX and SV

Actuator modules B and D

Actuator C

Actuator CS

Variants and Combination Options

The locking unit, in this example a M10A, can be combined or expanded because of the modular design of the SAFEMASTER STS system available in customized version. This makes a large number of options, alternatives, combinations and functions of units possible. For additional information refer to the data sheets of the individual modules and other basic units.

Important Note

Take advantage of the advice of the E. DOLD & SÖHNE KG specialists regarding the choice of units and combination of a system.

Ordering Designation

F-Kit for post dimension ($A = 50 \text{ mm} \times 50 \text{ mm}$) consisting of:

- End module M
Article number: 0060987
- Bayonet ring
Article number: 0060988
- Actuator module B
Article number: 0061873
- Switch module SV
Article number: 0062959
- Actuator F-Kit
Article number: 0064516

Different post dimensions available only upon request!

Actuator F-Kit ,

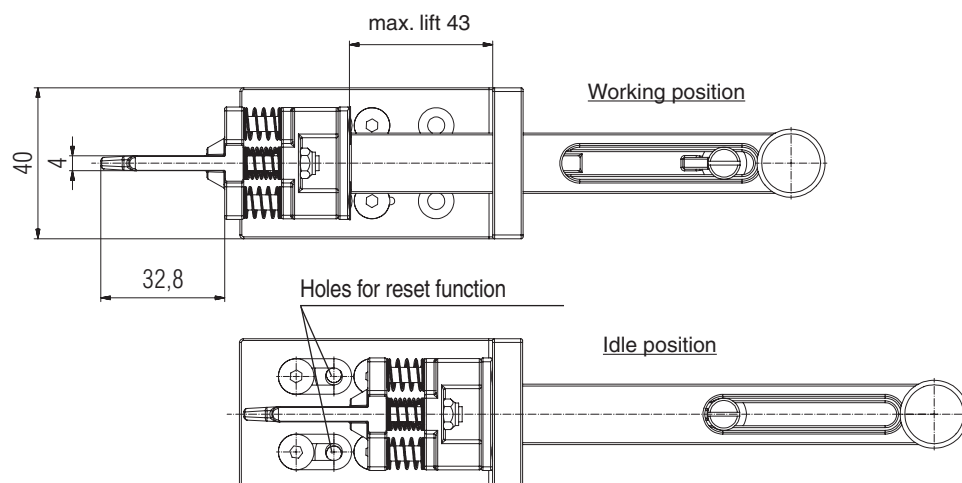
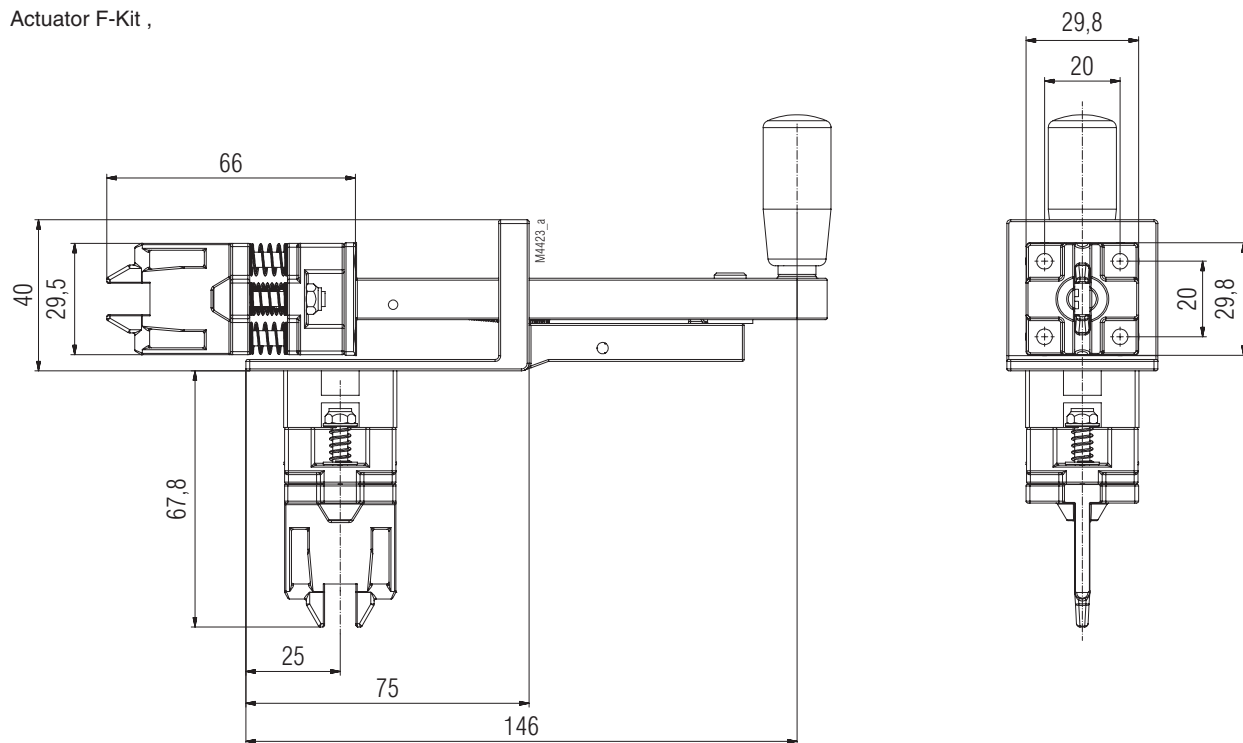

Profile insert

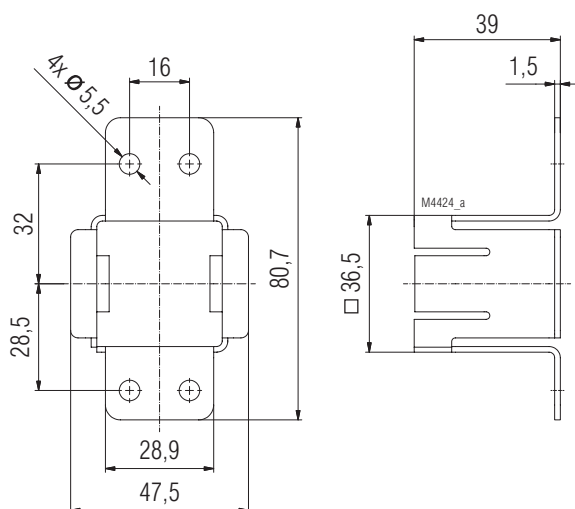

Please refer to the data sheets of the individual modules and basic units for dimensional drawings of the SVBM unit or the variable locking unit.

По вопросам продаж и поддержки обращайтесь:

Алматы (727)345-47-04
Ангарск (3955)60-70-56
Архангельск (8182)63-90-72
Астрахань (8512)99-46-04
Барнаул (3852)73-04-60
Белгород (4722)40-23-64
Благовещенск (4162)22-76-07
Брянск (4832)59-03-52
Владивосток (423)249-28-31
Владикавказ (8672)28-90-48
Владимир (4922)49-43-18
Волгоград (844)278-03-48
Вологда (8172)26-41-59
Воронеж (473)204-51-73
Екатеринбург (343)384-55-89

Иваново (4932)77-34-06
Ижевск (3412)26-03-58
Иркутск (395)279-98-46
Казань (843)206-01-48
Калининград (4012)72-03-81
Калуга (4842)92-23-67
Кемерово (3842)65-04-62
Киров (8332)68-02-04
Коломна (4966)23-41-49
Кострома (4942)77-07-48
Краснодар (861)203-40-90
Красноярск (391)204-63-61
Курск (4712)77-13-04
Курган (3522)50-90-47
Липецк (4742)52-20-81

Магнитогорск (3519)55-03-13
Москва (495)268-04-70
Мурманск (8152)59-64-93
Набережные Челны (8552)20-53-41
Нижний Новгород (831)429-08-12
Новокузнецк (3843)20-46-81
Ноябрьск (3496)41-32-12
Новосибирск (383)227-86-73
Омск (3812)21-46-40
Орел (4862)44-53-42
Оренбург (3532)37-68-04
Пенза (8412)22-31-16
Петрозаводск (8142)55-98-37
Псков (8112)59-10-37
Пермь (342)205-81-47

Ростов-на-Дону (863)308-18-15
Рязань (4912)46-61-64
Самара (846)206-03-16
Санкт-Петербург (812)309-46-40
Саратов (845)249-38-78
Севастополь (8692)22-31-93
Саранск (8342)22-96-24
Симферополь (3652)67-13-56
Смоленск (4812)29-41-54
Сочи (862)225-72-31
Ставрополь (8652)20-65-13
Сургут (3462)77-98-35
Сыктывкар (8212)25-95-17
Тамбов (4752)50-40-97
Тверь (4822)63-31-35

Тольятти (8482)63-91-07
Томск (3822)98-41-53
Тула (4872)33-79-87
Тюмень (3452)66-21-18
Ульяновск (8422)24-23-59
Улан-Удэ (3012)59-97-51
Уфа (347)229-48-12
Хабаровск (4212)92-98-04
Чебоксары (8352)28-53-07
Челябинск (351)202-03-61
Череповец (8202)49-02-64
Чита (3022)38-34-83
Якутск (4112)23-90-97
Ярославль (4852)69-52-93

Россия +7(495)268-04-70

Казахстан +(727)345-47-04

Беларусь +(375)257-127-884

Узбекистан +998(71)205-18-59

Киргизия +996(312)96-26-47

эл.почта: ddo@nt-rt.ru || сайт: <https://dold.nt-rt.ru/>